

GENESIS

Building Material Expert



HED

ANCHOR

COMPACT TOILET CUBICLE SYSTEM

GENESIS

Building Material Expert

Genesis works closely with architects and interior designers to meet the unique needs of diverse applications. Our expertise covers a wide range of areas, including lavatories, commercial spaces, offices, clubhouses, educational institutions, healthcare facilities, and sports venues. With exceptional knowledge and experience with over 7000 achieved projects.



OUR EXPERTISE



INTERNATIONAL BRANDS



From Idea to Reality

7000+

Projects specified and installed in HK and Macau

600+

Projects per year

25+

Years of expertise

OUR PARTNERS



GOVERNMENT COMMERCIAL CLUBHOUSE EDUCATION HOSPITAL



361° LAVATORY SOLUTION

Everything you want to know in the lavatory.

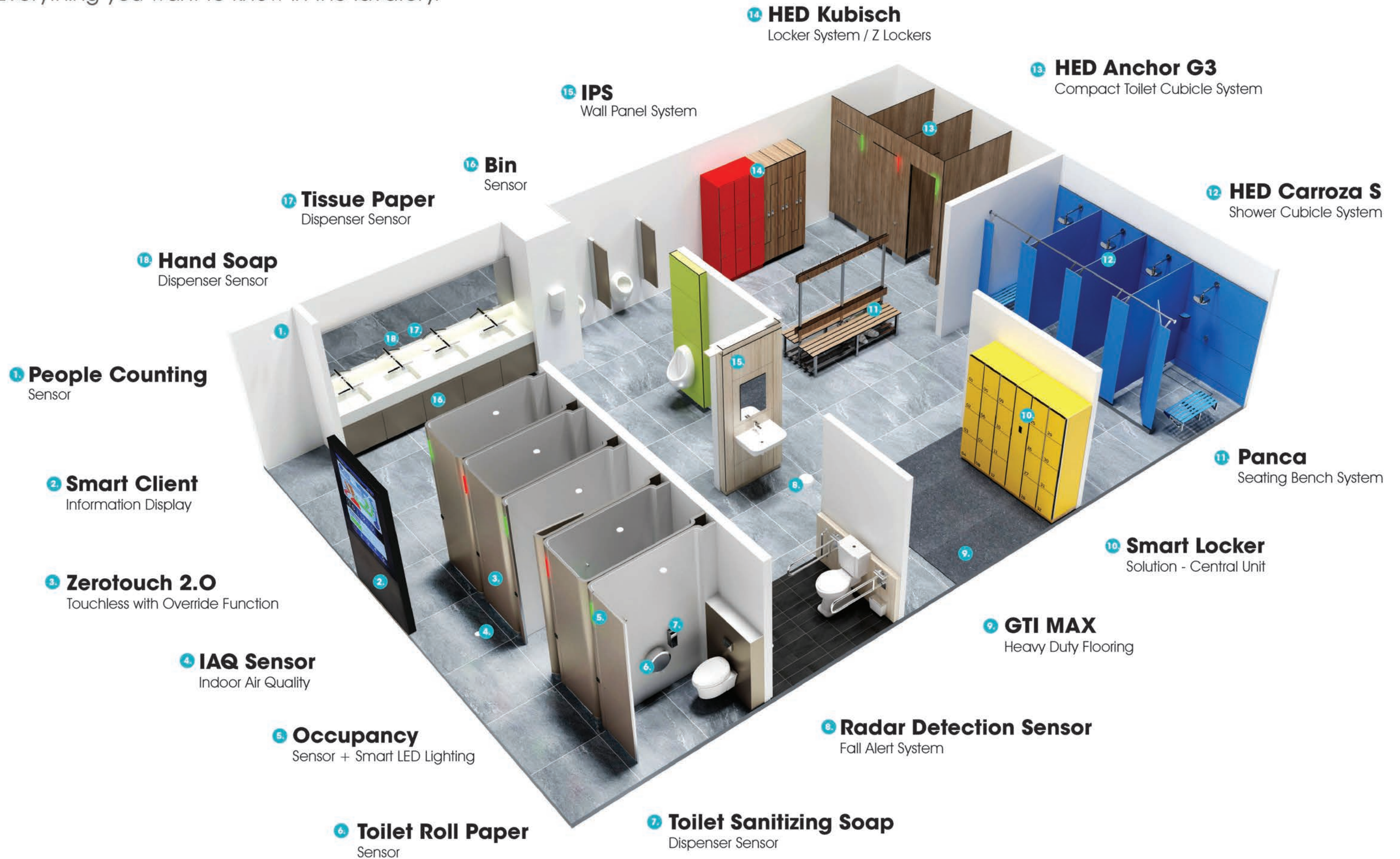



12/18 MM COMPACT
PANELS

IMPACT / SCRATCH /
MOISTURE RESISTANT

FINGER-PROTECTION
FEATURE

EXTREMELY
HYGIENIC

ANTI-SUICIDE
FEATURES

Table of Contents

Anchor Blaze Smart GIOT Cubicle	09
Anchor Insight Glass Cubicle	12
Anchor Elite Full-Height Cubicle	16
Anchor G5 - FA / CH Anti-Suicide Cubicle	20-24
Anchor G4 Ideal Cubicle	28
Anchor G3 Standard Cubicle	32
Carroza M1 / M2 Carroza Nylon Cubicle	36
Carroza S1 / S2 Carroza Stainless Steel Cubicle	46

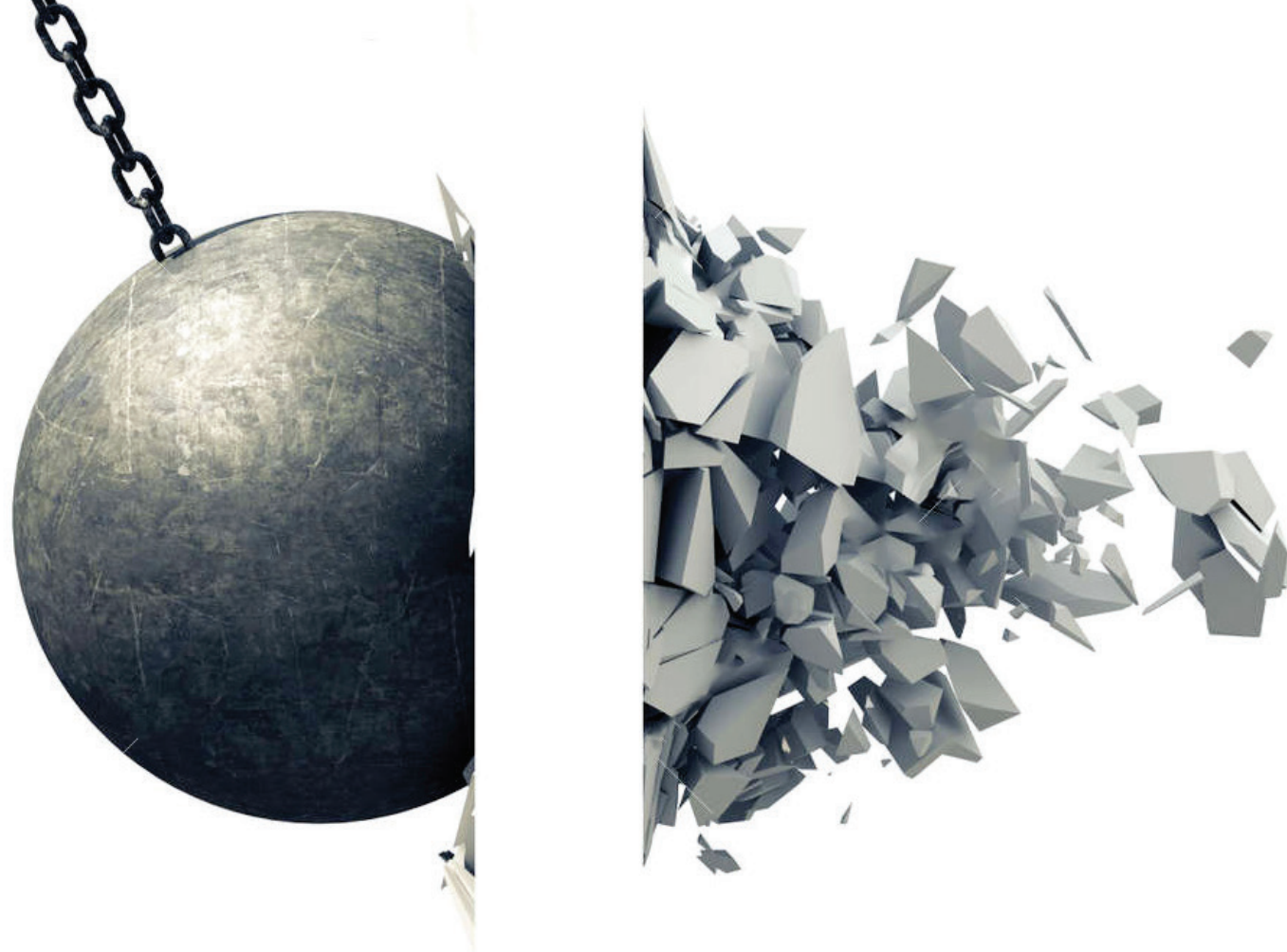

IMPACT AND SCRATCH RESISTANCE

HED Toilet Cubicle Partitions are meticulously engineered and constructed to withstand significant impacts, ensuring durability and **SAFETY** in high-traffic environments.

Our compact laminate board is constructed from multiple layers of high-quality kraft paper, reinforced by thermosetting resins under high pressure and temperature, with decorative paper on the surface. It is one kind of material that totally **water resistant, impact resistant, easy to clean, and durable.**

FUGRO TECHNICAL SERVICES LIMITED

Fugro Development Centre,
5 Lok Yi Street, Tai Lam,
Tuen Mun, N.T.,
Hong Kong.

Tel : +852 2450 8233
Fax : +852 2450 6138
E-mail : matlab@fugro.com.hk
Website : www.materialab.com.hk

Materialab

Certificate For Compact Laminate Panel

Testing of HED Compact Laminate Panel

For

Genesis Development Limited

This is to certify that the test results for the above mentioned laminate sheet comply with BS EN 438-2 : 2005 on the following test items

Assessment of Appearance Test
Thickness Test
Resistance to Immersion in Boiling Water Test
Resistance to Water Vapour Test
Resistance to Wet Condition Test
Resistance to Dry Heat Test
Dimensional Stability at Elevated Temperature
Resistance to Impact by Large Diameter Ball
Resistance to Crazeing Test
Resistance to Staining Test
Resistance to Cigarette Burns Test
Resistance to Scratching Test
Determination of Resistance to Surface Wear for High-pressure Decorative

Test results for the above tests are shown on our reports 100320ST110451 by this test laboratory.

Certified by : Ivan C.W. Chan

Ivan C.W. Chan

Authorised Signature

(Official Chop / Seal)

Date Issued : 6.5.2013

The copyright of this document is owned by Fugro Technical Services Limited. It may not be reproduced except with prior written approval from the Company.

GEN01/0312



MOISTURE & WATER RESISTANCE

HED Toilet Cubicle Partitions

It is water resistance, fire resistance, impact resistance, easy cleaning, reliable quality and durability. Especially suitable for airport, stations, hospitals, schools, office buildings, shopping malls, stadiums and other places with high traffic.

Features

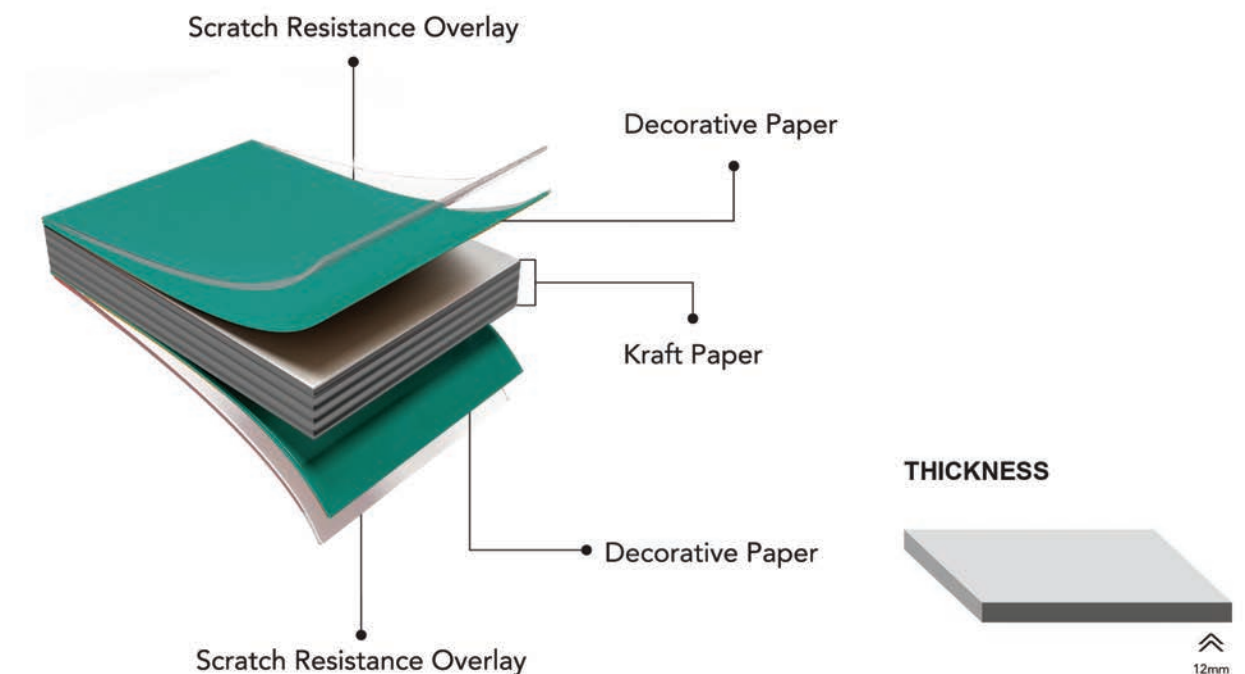

Durability

High-pressure laminate is an indispensable material for high-quality toilet and shower partitions. Although Compact laminated panels aren't as flame-resistant as concrete or steel, they are still highly durable and they offer far more fire protection than traditional wood and drywall-constructed interior walls, or exterior vinyl applications.

Built to Last

Our Toilet Cubicle Partitions are built to last, protect privacy, and can be customized to meet the needs of your project. With moisture resistance surfaces that stand up to mold and mildew, these strong partitions not only look good, but will save you time and money on ongoing maintenance.



ANCHOR BLAZE

SMART LED TOILET CUBICLE SYSTEM



MIRAPLACE MALL



WINDSOR HOUSE

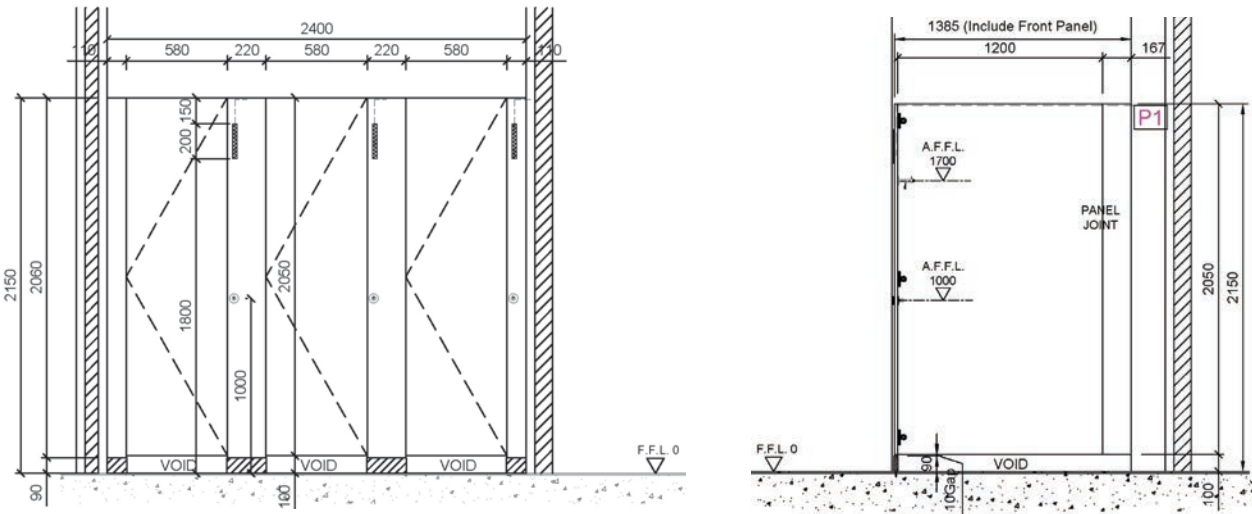
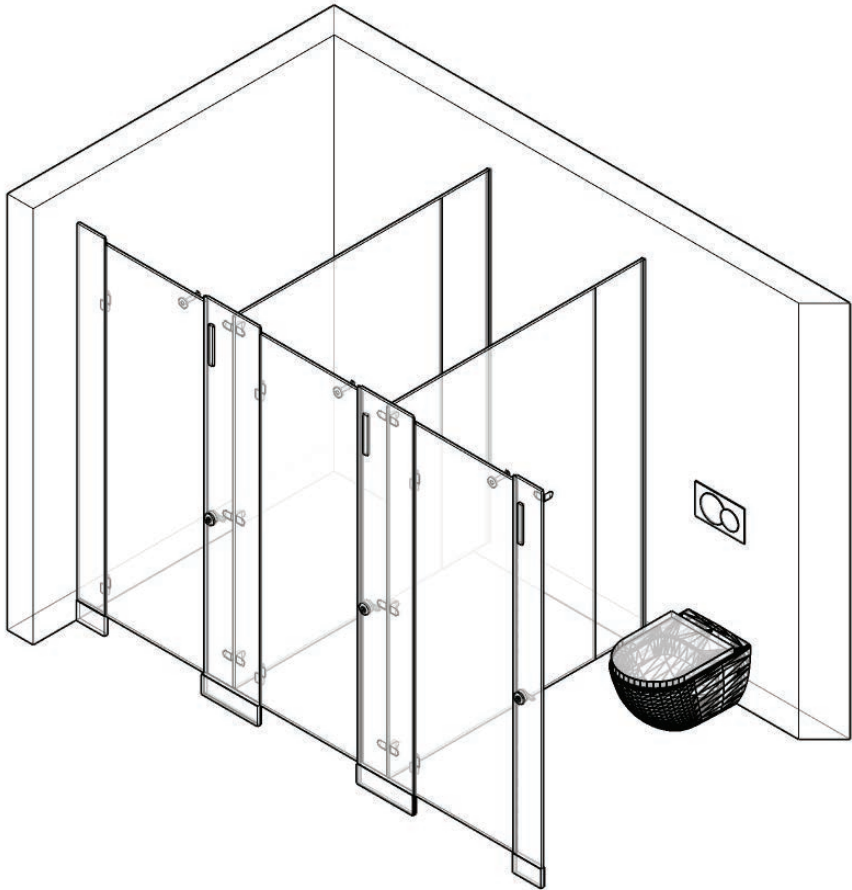

Hardware & Accessories



HED-SS1
304 / 316 Stainless Steel

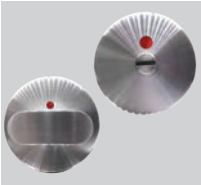

SS-IN1 Stainless Steel Door Lock



HED-DH01SS-1
304 / 316 Stainless Steel



HED-DH01SS-2
304 / 316 Stainless Steel



CH-02AL Aluminium Coat Hook with Door Stopper



CH-01ASS Stainless Steel Coat Hook

Anchor Blaze

Dimension

- Door**
1800mmW x 2250mmH
- Depths**
1350mm - 1500mm
- Partitions**
2400mm (FFL)
- Floor Clearance**
150mmH

Specification

- Model**

Anchor Blaze was type of Cubicle system that was integrated by Smart GIOT Solution and was made of 12/13mm TUF water resistance compact panels. Doors feature a flush design. Doors manufactured with all edges bevelled and corners rounded with 2 mm radius.
- Pilasters, Doors and Partitions**

Pilasters, doors and partitions in 12/13mm TUF water resistance compact panels. Doors feature a flush design. Doors manufactured with all edges bevelled and corners rounded with 2 mm radius.
- Hardware**

HED engineering ironmongeries must applied, including action hinges with soft closing, angle brackets with security screws, indicator lock with emergency opening and coat hook with integrated rubber door stopper.
- Construction**

Cubicle system made of 12/13mm TUF water resistance compact panels with the finest stainless steel ironmongery for maximum stability. This commercial grade cubicle system emphasize on simplicity and durability as well as versatile product resistant to vandalism, impact and water.
- Floor Anchor**

HED SS316 Stainless Steel Anchor F1 Mechanism applied for floor-anchored system.



ANCHOR INSIGHT

Genesis 361 Glass Toilet Cubicle Solution



THE ONE



V-CITY



OCEAN PARK

ANCHOR INSIGHT offers innovative Architects a delighting element in GLASS, adding attributes such as strength, style, durability and functionality to the modern cubicle designs. The combination of ANCHOR INSIGHT's aesthetics and functionality makes this cubicle system one of the most sought after products in modern cubicle design.



Anchor Insight

Dimension

Specification

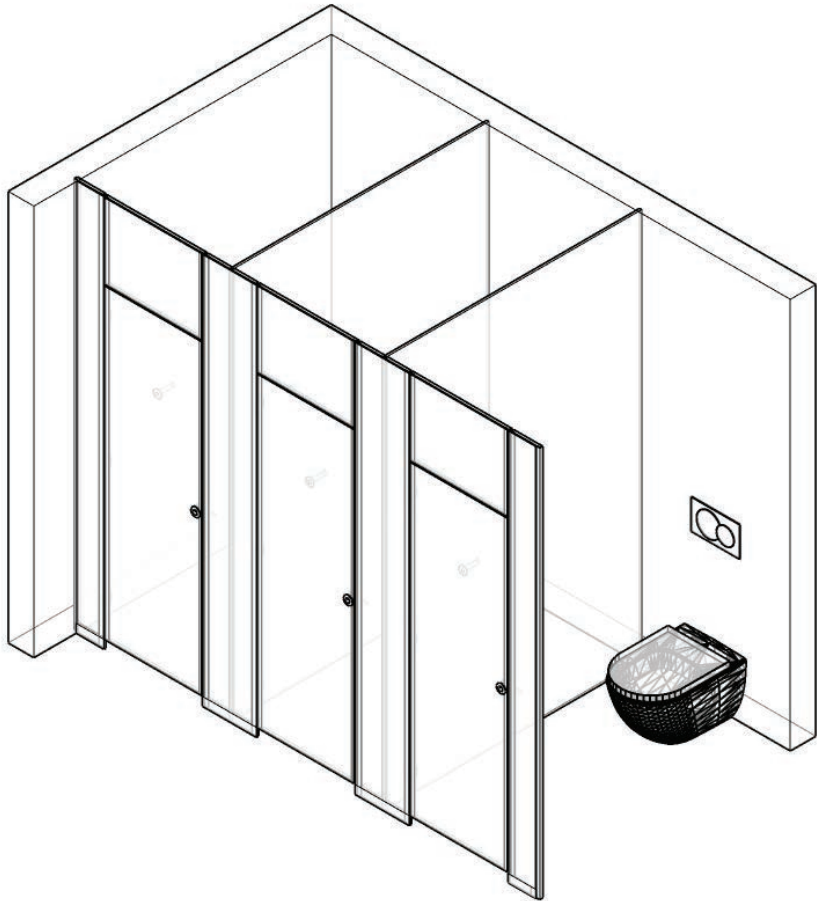

Door
1800mmW x 2250mmH

Depths
1350mm - 1500mm

Partitions
2400mm (FFL)

Floor Clearance
150mmH

Construction

Glass cubicle system made of 12/13mm TUF water resistance compact panels with 5mm “Vidrio” safety glass surface, solid stainless steel ironmongery for maximum stability. This premium grade cubicle system is hygienic, durable, luxury and versatile product resistant to vandalism, impact and water.

Material

11.5mm “Vidrio” laminated & tempered glass with VIR interlayer or 5mm VC reinforced back paint tempered glass with relevant thickness. 12/13mm TUF water resistance compact panels with even black core according to EN 438 (BS EN 438-2: 2005). CNC fabrication processing to ensure all sharp edges are rounded for enhanced safety.

Pilasters, Doors and Partitions

Pilasters, doors and partitions in 12/13mm TUF water resistance compact panels. Doors feature a flush design with functional HED glass lipping trim edges to accommodate hinges and quiet rubber bumpers. Doors manufactured with all edges bevelled and corners rounded with 2 mm radius.

Floor Anchors

HED SS316 Stainless Steel Anchor F1, F2 or F3 Mechanism applied for relevant floor-anchored system.

Hardware & Ironmongeries:

HED engineering ironmongeries must applied, including action hinges with soft closing, angle brackets with security screws, indicator lock with emergency opening and coat hook with integrated rubber door stopper.

Option:

Anti-bacterial panel is optional according to [JIS Z 2801:2000] standard.

Finish Options

6 mm Temp

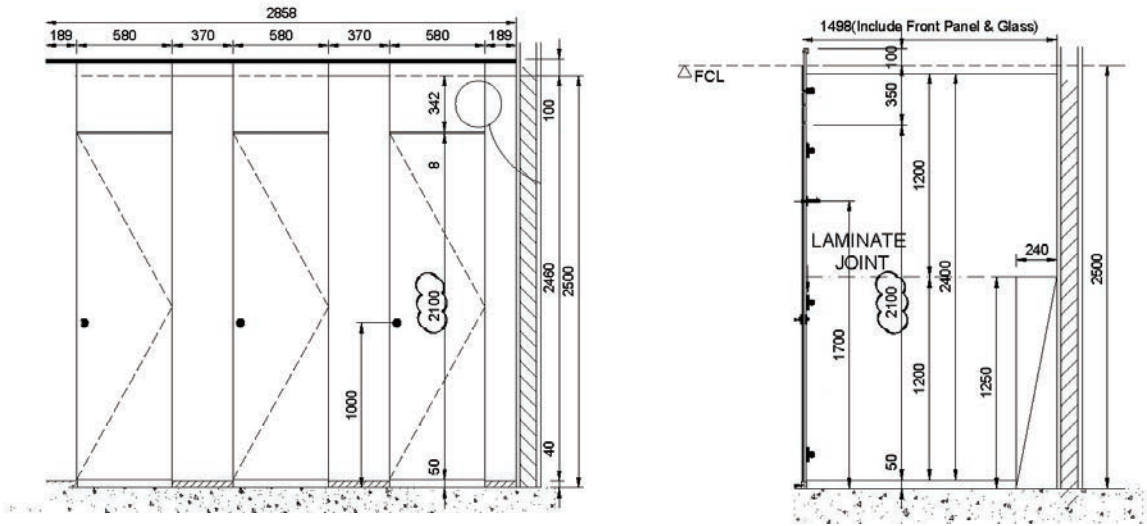

Hardware & Accessories

HED-SS1
304 / 316 Stainless Steel

SS-IN1 Stainless Steel Door Lock

HED-DH01SS-1
304 / 316 Stainless Steel

HED-DH01SS-2
304 / 316 Stainless Steel

CH-02AL Aluminium Coat Hook with Door Stopper

CH-01ASS Stainless Steel Coat Hook



ANCHOR ELITE

Genesis 361 Full-Height Toilet Cubicle Solution



Our Anchor Elite Full-Height toilet cubicles are the ultimate in durability, strength and style, satisfying your need for extra privacy. The doors and partitions of our Full-Height washroom cubicles are supplied in TUF compact panel, fully water and corrosion resistance.



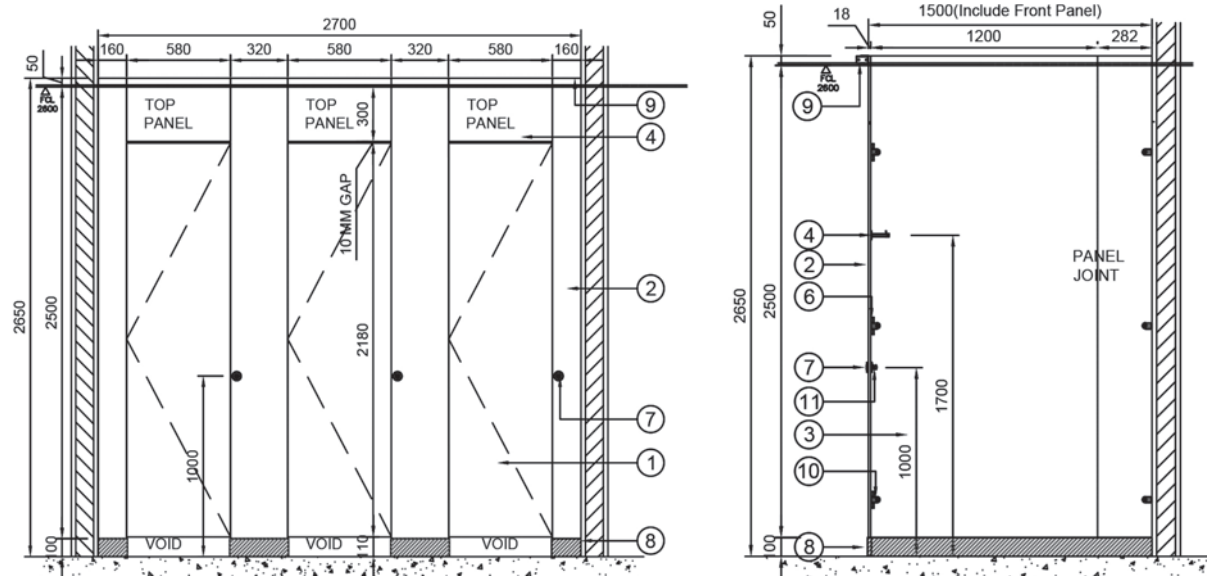
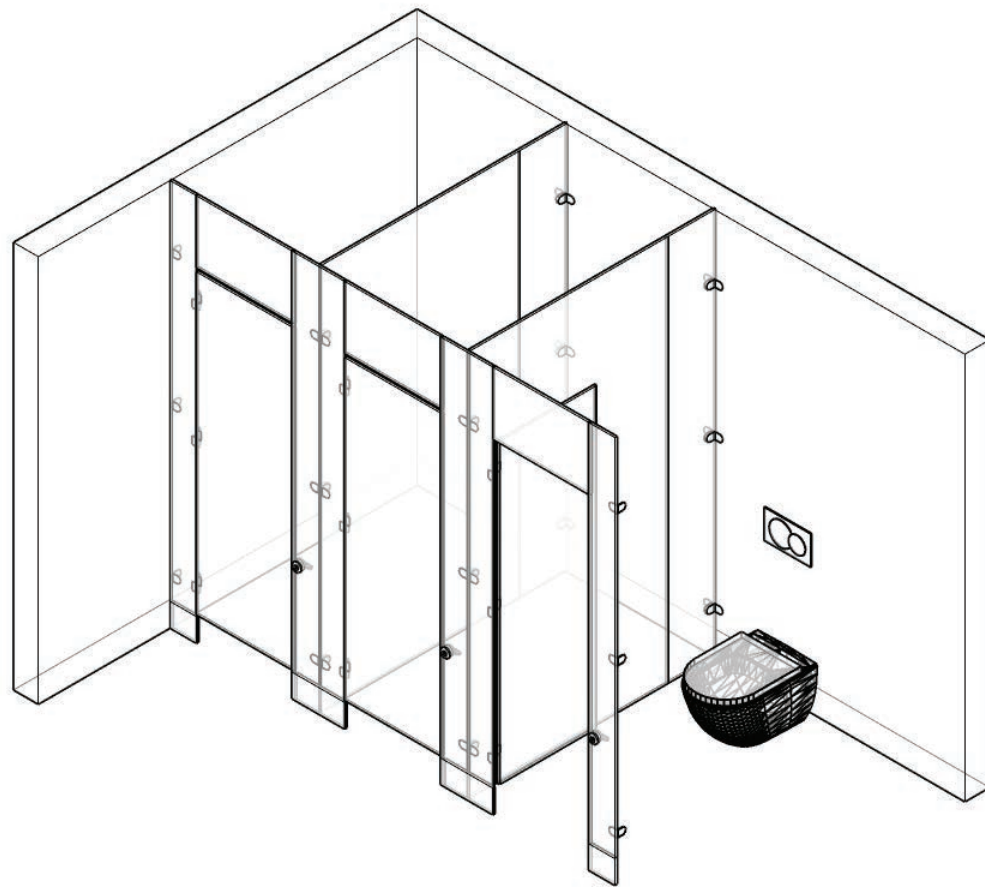

Hardware & Accessories



HED-SS1
304 / 316 Stainless
Steel

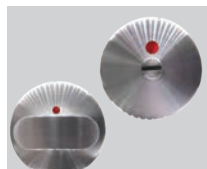

SS-IN1 Stainless Steel Door Lock



HED-DH01SS-1
304 / 316 Stainless
Steel



HED-DH01SS-2
304 / 316 Stainless
Steel



CH-02AL Aluminium
Coat Hook with Door
Stopper



CH-01ASS
Stainless Steel
Coat Hook

Anchor Elite

Dimension

Door

1800mm - 2250mm

Depth

1500mm -1800mm

Partitions

2400mm (FFL)

Floor Clearance

50 - 150 mm

Specification

Model

Genesis HED ELITE Cubicle system
made of HED TUF water resistance
Stratificato panels with the finest
stainless-steel ironmongery for
stability, simplicity, durability and
versatile product resistant to
vandalism, impact and water.

Construction

Full-Height cubicle system made of 12/18mm TUF water resistance compact panels with the finest stainless steel ironmongery for maximum stability. This commercial grade cubicle system is durable, economic and versatile product resistant to vandalism, impact and water.

Material

12/18mm TUF water resistance compact panels with even black core according to EN 438 (BS EN 438-2 : 2005). CNC fabrication processing to ensure all sharp edges are rounded for enhanced safety.

Pilasters, Doors and Partitions

Pilasters, doors and partitions in 12/18mm thick TUF water resistance compact panels. Doors feature a flush design with functional lipping trim edges to accommodate hinges and quiet rubber bumpers. Doors manufactured with all edges bevelled and corners rounded with 2 mm radius.

Hardware & Ironmongeries

HED engineering ironmongeries must applied, including action hinges with soft closing, angle brackets with security screws, indicator lock with emergency opening and coat hook with integrated rubber door stopper.

Floor Anchors

HED SS316 Stainless Steel Anchor F1 Mechanism is applied for floor-anchored system.

Option:

Anti-bacterial panel is optional according to [JIS Z 2801:2000] standard.

Finish Options

TUF Wood
TUF Solid Color

THE ANTI-SUICIDE TOILET CUBICLE

The risk of committing suicide in washrooms are increasingly high for the past years, especially for the youths and hospital patients. Either used by rope or anything they can tied up to hang themselves are the common factors.

THE SOLUTION

To prevent this, Our HED Anchor G5 Series are cubicles that are well-designed to prevent suicidal attempts. It is a headrail – free system that features and hinders of committing unfortunate actions.





ANCHOR G5 - CH

ANTI-SUICIDE

COMPACT TOILET CUBICLE SYSTEM



HED™ Anchor G5CH is an elaborate system which feature completely unobstructed floor to facility easy cleaning and maintenance. It's perfect architectural structure and design are also highly appreciated by designers and end-users.

ANTI-SUICIDE DESIGN

approved for hospital or healthcare requirement.



Anchor G5-CH

Dimension

Specification

Door
1800-2250 mm,

Depths
1500-1800 mm

Partitions
2400 mm (FFL)

Floor Clearance
50 - 150 mm

Model

The ceiling hang cubicle system made of 12/18mm TUF water resistance compact panels with the finest stainless steel ironmongery for maximum stability. This special designed grade cubicle system is durable, impact and vandalism resistant as well as maintenance free.

Construction

The ceiling hang cubicle system made of 12/18mm TUF water resistance compact panels with the finest stainless steel ironmongery for maximum stability. This special designed grade cubicle system is durable, impact and vandalism resistant as well as maintenance free.

Material

12/18mm TUF water resistance compact panels with even black core according to EN 438 (BS EN 438-2 : 2005). CNC fabrication processing to ensure all sharp edges are rounded for enhanced safety.

Ceiling Anchors

HED SS316 Stainless Steel Ceiling Anchor F3 Mechanism for ceiling enhancement facility.

Pilasters, Doors and Partitions

Pilasters, Doors & Partitions: Pilasters, doors and partitions in 12/18mm TUF water resistance compact panels. Doors manufactured with all edges bevelled and corners rounded with 2 mm radius.

Hardware & Ironmongery

HED engineering ironmongeries must applied, including action hinges with soft closing, angle brackets with security screws, indicator lock with emergency opening and coat hook with integrated rubber door stopper.

Option:

Anti-bacterial panel is optional according to [JIS Z 2801:2000] standard.

Finish Options

TUF Wood
TUF Solid Color

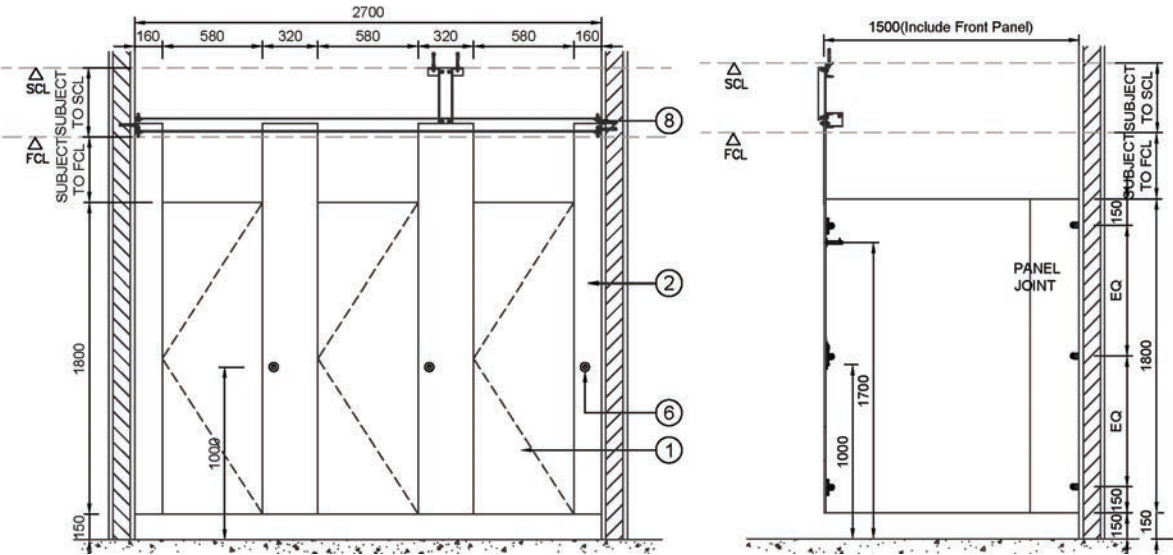
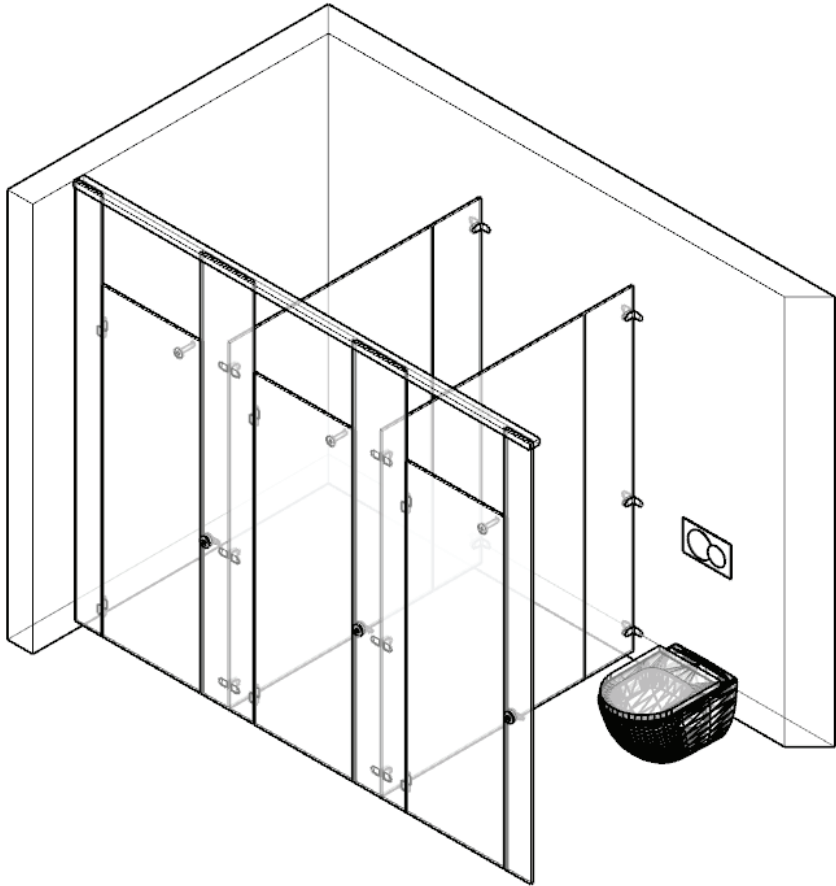

Hardware & Accessories



HED-SS1
304 / 316 Stainless Steel

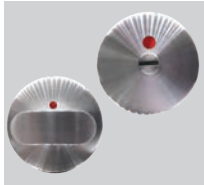

SS-IN1 Stainless Steel Door Lock



HED-DH01SS-1
304 / 316 Stainless Steel



HED-DH01SS-2
304 / 316 Stainless Steel



SF_01SS
Angle Bracket



CH-01ASS
Stainless Steel Coat Hook



ANCHOR G5 - FA

ANTI-SUICIDE
COMPACT TOILET CUBICLE SYSTEM



QUEEN MARY HOSPITAL



TIN SHUI WAI HOSPITAL

HED™ Anchor G5 FA is a safety **NON-HEADRAIL** system specified by hospital and healthcare facilities for **ANTI-SUICIDE DESIGN**, a common unfortunate occurrence in standard cubicle systems. Moreover, Anchor G5FA system with build in extra reinforced durable structure make it perfect for schools or sports facilities.

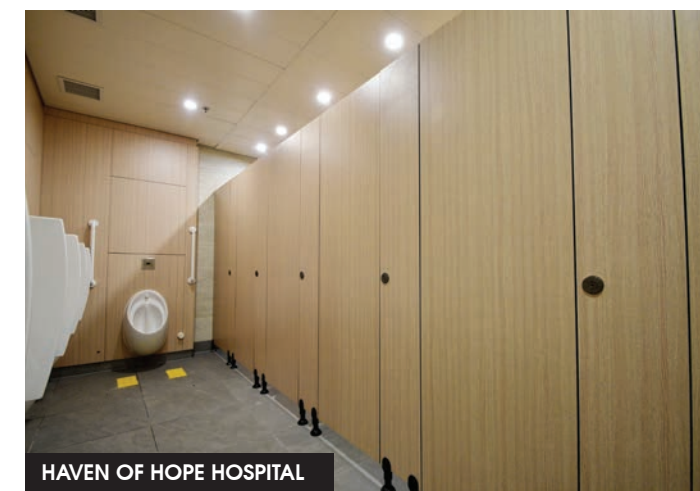

HAVEN OF HOPE HOSPITAL

Anchor G5-FA

Dimension Specification

Door
1800mm - 2000 mm

Width
800 - 900 mm

Depths
1500 -1800 mm

Partitions
1950 mm (FFL)

Floor Clearance
50 - 150 mm

Model

Genesis HED Anchor G5-FA Cubicle system made of HED TUF water resistance Stratificato Solid Phenolic panels with finest stainless-steel ironmongery for stability, simplicity, durability and versatile product resistant to vandalism, impact and water.

Construction

Cubicle system made of 12/18mm TUF water resistance compact panels with stainless steel ironmongery for maximum stability. This hygienic, non-headrail cubicle system is designed for more spacious and anti-suicide as well as impact and vandalism resistant.

Material

12/18mm thick self-supporting panels with even black core according to EN 438 (BS EN 438-2 : 2005). CNC fabrication processing to ensure all sharp edges are rounded for enhanced safety.

Pilasters, Doors and Partitions

Pilasters, doors and partitions in 12/18mm TUF water resistance compact panels. Doors manufactured with all edges bevelled and corners rounded with 2 mm radius.

Hardware & Ironmongery

HED engineering ironmongeries must applied, including action hinges with soft closing, angle brackets with security screws, indicator lock with emergency opening and coat hook with integrated rubber door stopper.

Adjustable Foot

HED SS316 Stainless Steel Anchor F5 Mechanism applied for floor-anchored system.

Option:

Anti-bacterial panel is optional according to [JIS Z 2801:2000] standard.

Finish Options

TUF Wood
TUF Solid Color

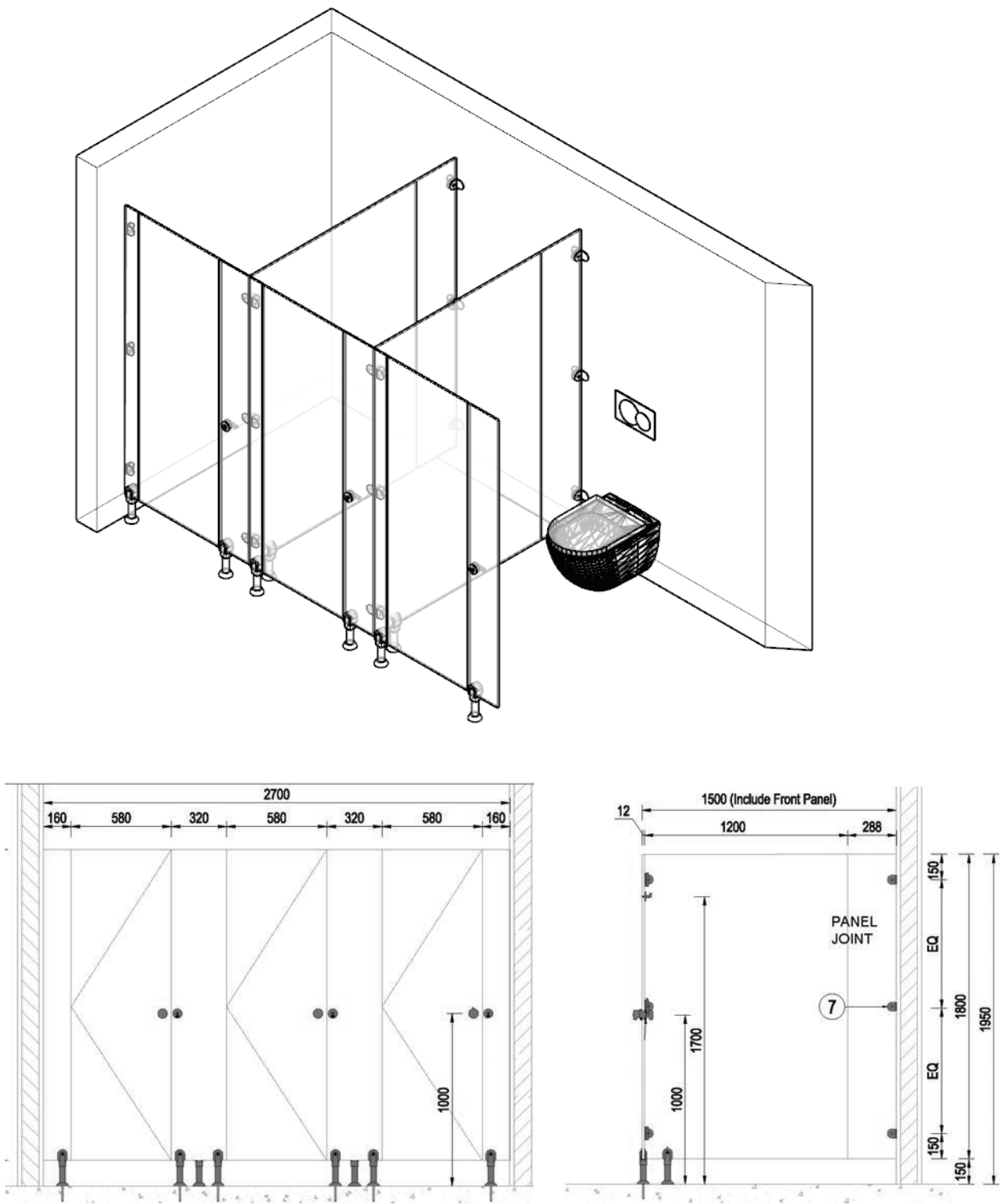

Hardware & Accessories



HED-SS1
304 / 316 Stainless Steel

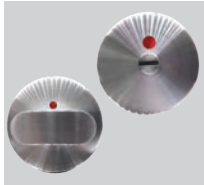

SS-IN1 Stainless Steel Door Lock



HED-DH01SS-1
304 / 316 Stainless Steel



HED-DH01SS-2
304 / 316 Stainless Steel



SF_01SS
Angle Bracket



CH-01ASS
Stainless Steel Coat Hook



ANCHOR G4

COMPACT TOILET CUBICLE SYSTEM



MIRA PLACE MALL



TIU KING LENG SHOPPING MALL

ANCHOR G4 offer architects a toilet cubicle system of minimal design with the highest quality engineered components, the large floor anchor support allows for free standing cubicle without headrails, making the system more space saving in high traffic lavatory interiors.

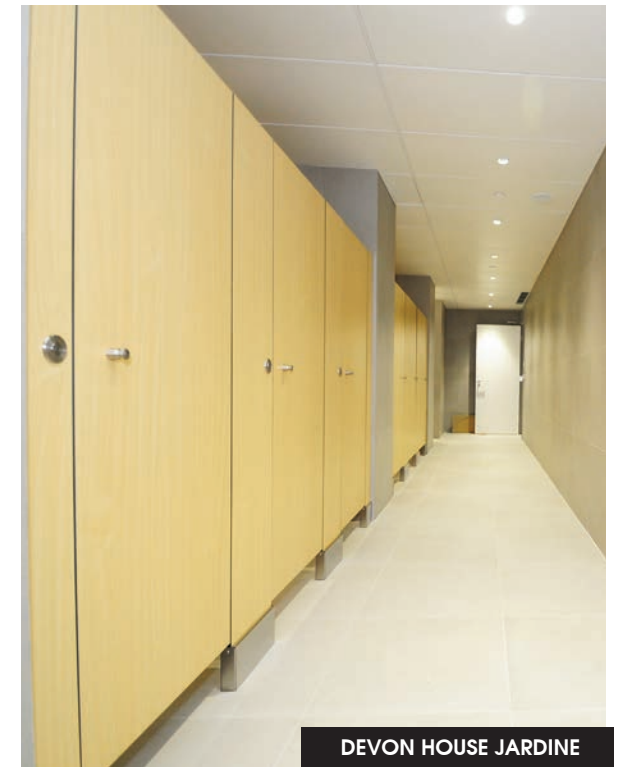

DEVON HOUSE JARDINE



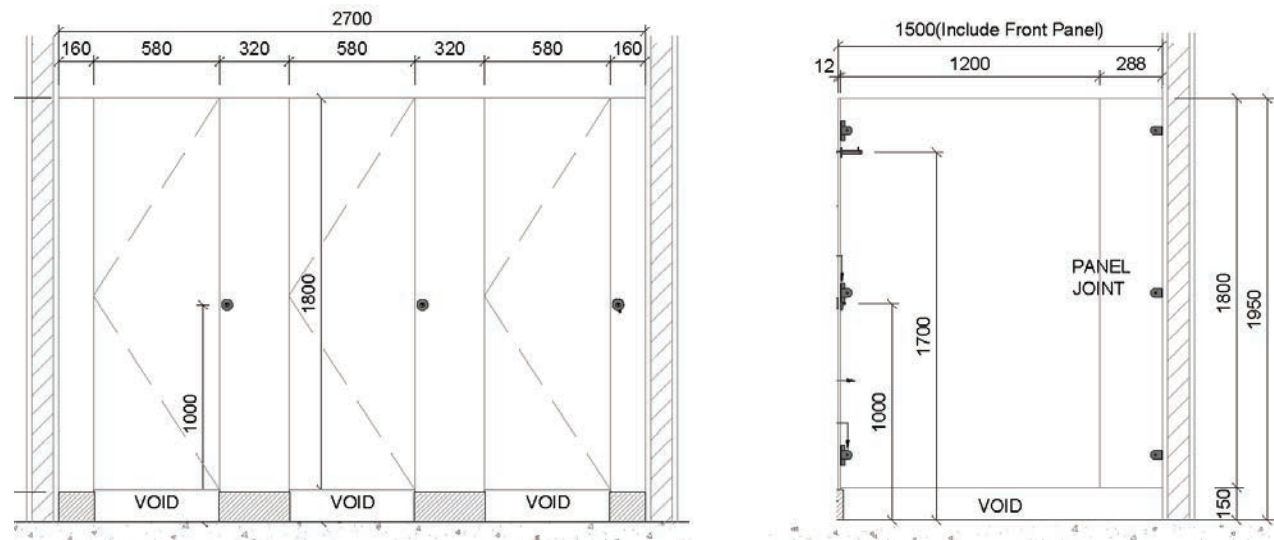
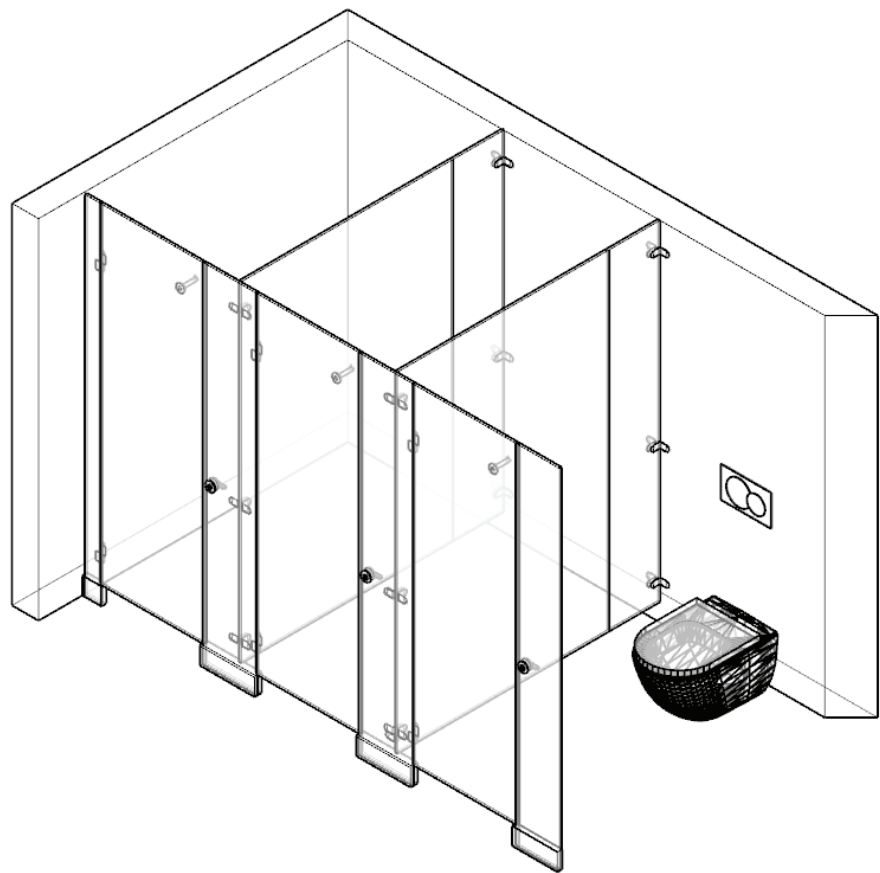

Hardware & Accessories



HED-SS1
304 / 316 Stainless Steel

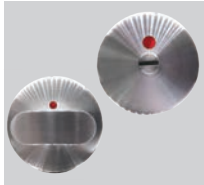

SS-IN1 Stainless Steel Door Lock



HED-DH01SS-1
304 / 316 Stainless Steel



HED-DH01SS-2
304 / 316 Stainless Steel



SF_01SS
Angle Bracket



CH-01ASS
Stainless Steel Coat Hook

Anchor G4

Dimension

- Door**
1800-2200 mm
- Width**
800-900 mm
- Partitions**
1800-2100 mm (FFL)
- Floor Clearance**
50 - 150 mm

- Depths**
1500 - 1800 mm

Specification

- Model**

Genesis HED Anchor G4 Cubicle system made of HED TUF water resistance Stratificato panels with the finest stainless-steel ironmongery for stability, simplicity, durability and versatile product resistant to vandalism, impact and water.
- Pilasters, Doors and Partitions**

Pilasters, doors and partitions in 12/18mm TUF water resistance compact panels. Doors manufactured with all edges bevelled and corners rounded with 2 mm radius.
- Hardware & Ironmongery**

HED engineering ironmongeries must applied, including action hinges with soft closing, angle brackets with security screws, indicator lock with emergency opening and coat hook with integrated rubber door stopper.
- Construction**

Cubicle system made of 12/18mm TUF water resistance compact panels with the finest stainless steel ironmongery for maximum stability. This elegant, non-headrail cubicle system is durable, economic and versatile product resistant to vandalism, impact and water.
- Floor Anchors**

HED SS316 Stainless Steel Anchor F4 Mechanism applied for relevant floor-anchored system.
- Material**

12/18mm TUF water resistance compact panels with even black core according to EN 438 (BS EN 438-2 : 2005). CNC fabrication processing to ensure all sharp edges are rounded for enhanced safety.
- Option:**

Anti-bacterial panel is optional according to [JIS Z 2801:2000] standard.
- Finish Options**

TUF Wood
TUF Solid Color



ANCHOR G3 / G3U

COMPACT TOILET CUBICLE SYSTEM



WINDSOR HOUSE

P.H.C. WING KWONG COLLEGE



ANCHOR G3U

TIMES SQUARE



ANCHOR G3



ANCHOR G3U

ANCHOR G3 is a strong and durable cubicle system with finest stainless steel fittings designed for long term durability the construction details are all professionally designed and manufactured to withstand heavy traffic and frequent usage.

PING SHAN KIU TAU WAI



ANCHOR G3

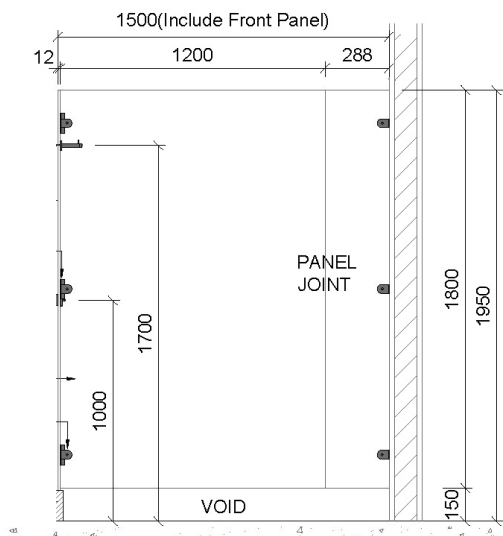
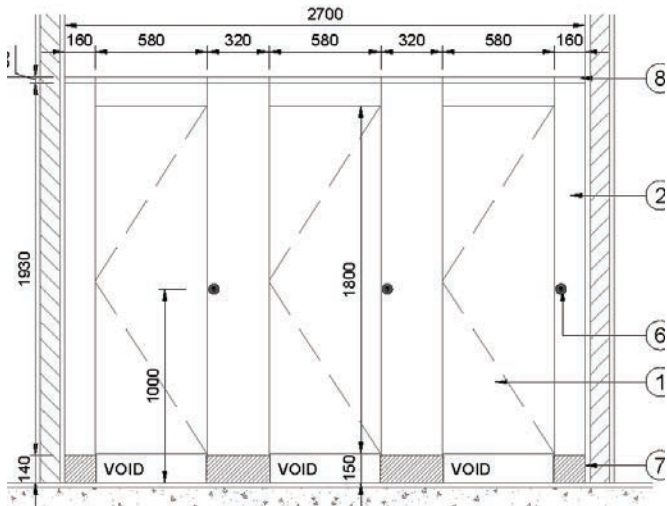
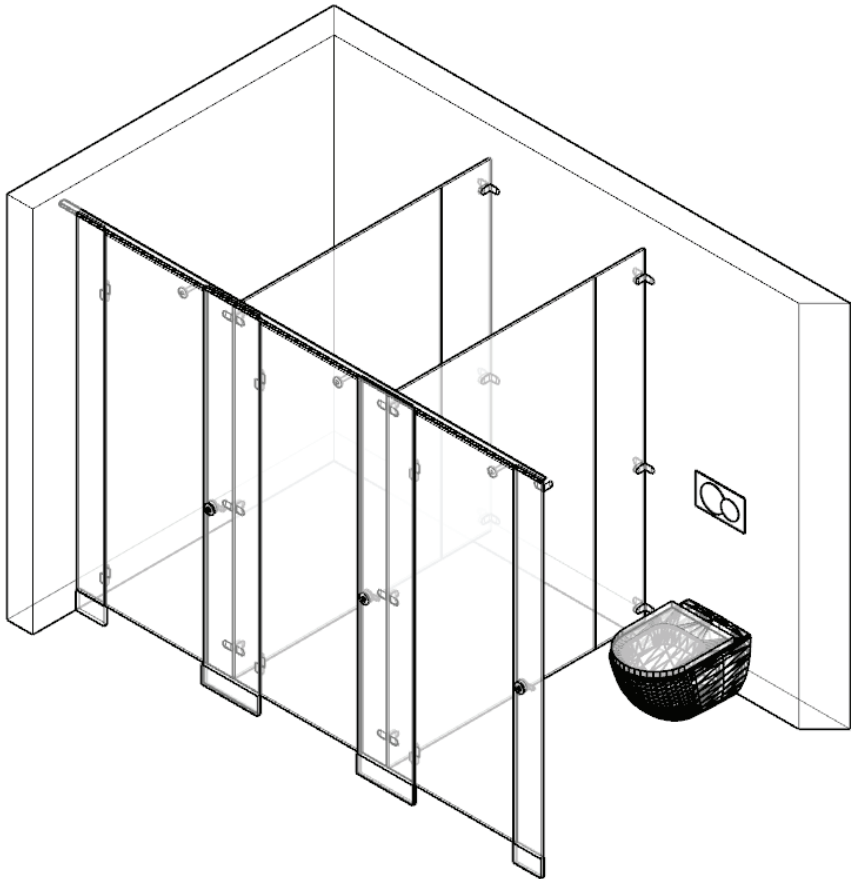

Hardware & Accessories



HED-SS1
304 / 316 Stainless Steel

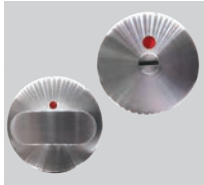

SS-IN1 Stainless Steel Door Lock



HED-DH01SS-1
304 / 316 Stainless Steel



HED-DH01SS-2
304 / 316 Stainless Steel



SF_01SS
Angle Bracket



CH-01ASS
Stainless Steel Coat Hook

Anchor G3

Dimension

Door
1800-2000 mm

Width
800-900 mm

Partitions
1800-2100 mm (FFL)

Floor Clearance
50 - 150 mm

Depths
1350 - 1500 mm

Specification

Model

Cubicle system made of 12/13mm TUF water resistance compact panels with the finest stainless steel ironmongery for maximum stability. This commercial grade cubicle system emphasize on simplicity and durability as well as versatile product resistant to vandalism, impact and water.

Construction

Cubicle system made of 12/13mm TUF water resistance compact panels with the finest stainless steel ironmongery for maximum stability. This commercial grade cubicle system emphasize on simplicity and durability as well as versatile product resistant to vandalism, impact and water.

Material

12/13mm TUF water resistance compact panels with even black core according to EN 438 (BS EN 438-2 : 2005). CNC fabrication processing to ensure all sharp edges are rounded for enhanced safety.

Pilasters, Doors and Partitions

Pilasters, doors and partitions in 12/13mm TUF water resistance compact panels. Doors feature a flush design. Doors manufactured with all edges bevelled and corners rounded with 2 mm radius.

Hardware & Ironmongery

HED engineering ironmongeries must applied, including action hinges with soft closing, angle brackets with security screws, indicator lock with emergency opening and coat hook with integrated rubber door stopper.

Floor Anchor

HED SS316 Stainless Steel Anchor F1 Mechanism applied for floor-anchored system.

Option:

Anti-bacterial panel is optional according to [JIS Z 2801:2000] standard.

Finish Options

TUF Wood
TUF Solid Color



CARROZA M1

CLASSIC COMPACT TOILET CUBICLE SYSTEM



AMERICAN SCHOOL HONG KONG



Carroza M1 is a classic cubicle system designed for long term reliability and durability. The unlimited colour choice and wide range of finishes offer innovative design features to Architects.

It also provides maximum versatility in appearance and flexibility in application for every toilet design.



KWAI CHUNG HOSPITAL



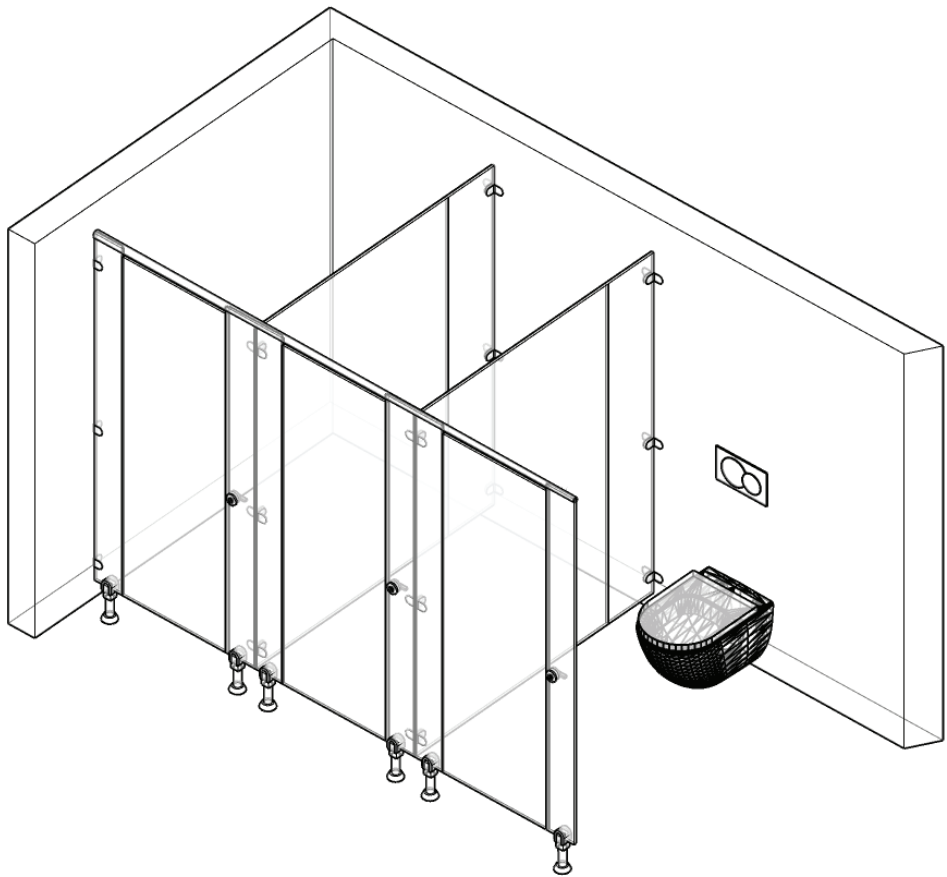

Carroza M1

Dimension

Specification

- Door**
600mmW x 1980mmH
- Division Panel:**
1500mmD x 1980mmH
- Pilaster**
150 - 200mmW x 1980mmH

Floor Clearance
50 - 150 mm

- Model**

Genesis HED Mote Cubicle system made of HED TUF water resistance Stratificato panels with the finest stainless-steel ironmongery for stability, simplicity, durability and versatile product resistant to vandalism, impact and water.
- Pilasters, Doors and Partitions**

Pilasters, doors and partitions are made of HED TUF water resistance Stratificato panels. Doors manufactured with all edges beveled and corners rounded with 2 mm radius.
- Construction**

12 or 13mm thick Stratificato panel of impregnated homogenous core with both sides decorative paper against melamine resin subjected to the combined action of pressure (9m Pa) and heat (150°C) in hydraulic presses core according to EN-438 absolutely moisture resistant, rot-proof, scratch and impact resistant, sturdily fitted together. Fabricated by CNC machine to ensure quality edge finish and safety corner
- Hardware & Ironmongery**

HED engineering ironmongeries must be applied, including gravity door hinges, angle brackets, indicator lock with emergency opening and coat hook with integrated rubber door stopper function. HED 2.0 Nylon adjustable foot system (100-150mm) anchored to the floor with stainless inserts is corrosion and rust resistant.
- Finish Options**



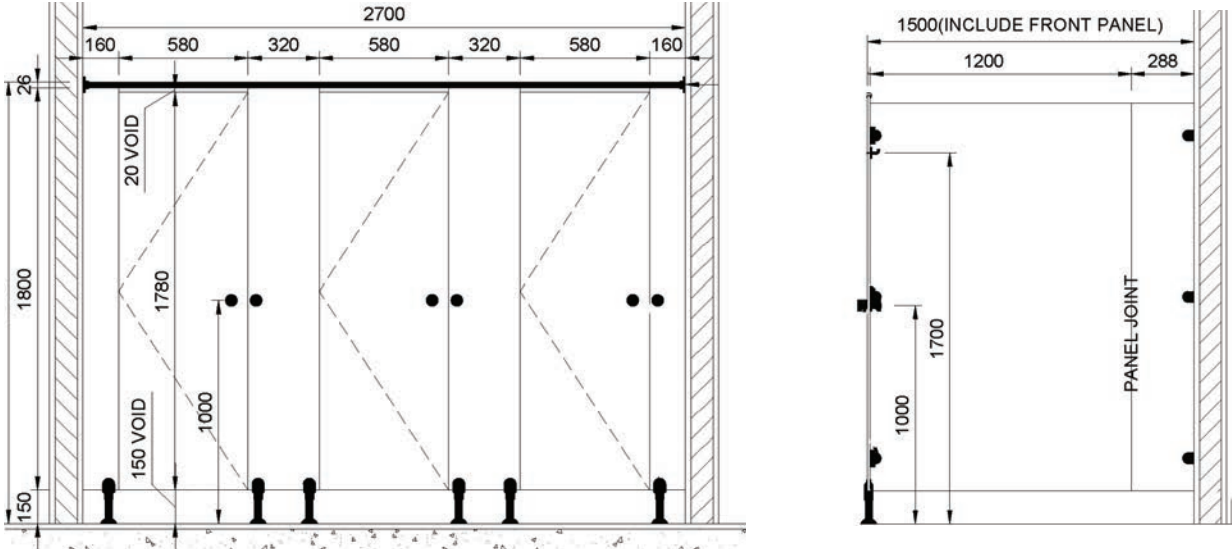

TUF Wood
TUF Solid Color

Material

12/13mm TUF water resistance compact panels with even black core according to EN 438 (BS EN 438-2 : 2005). CNC fabrication processing to ensure all sharp edges are rounded for enhanced safety.



Hardware & Accessories

				
NIL-H01 Nylon Indicator Lock	NH-H01 Nylon Handle	NH-001 Nylon Hinge	NCH-002 Nylon Coathook	NAF-003 Nylon Anchor Foot



CARROZA M2

FLOATING COMPACT TOILET CUBICLE SYSTEM

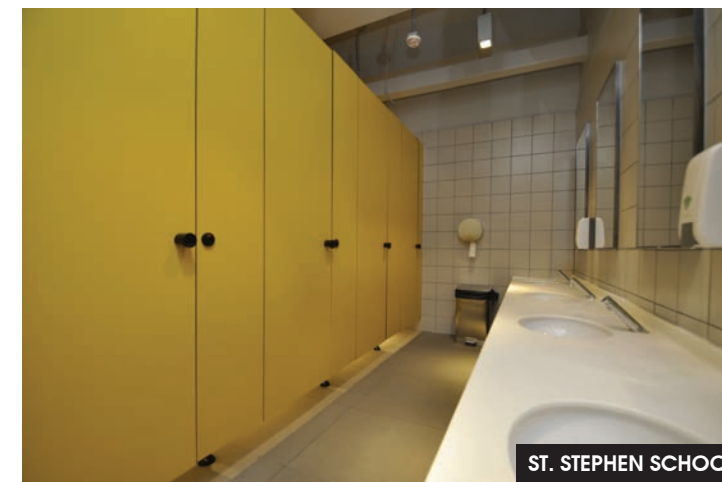

ST. STEPHEN SCHOOL



BOC SHAU KEI WAN

Carroza M2 is a type of cubicle system that is floating and designed for long term reliability and durability. The features emphasizes on its headrail and foot support are hidden inside that provides the seamlessly look and levitating effect of the cubicle appearance.



SPORTS CENTRE & LIBRARY. TKO



CHINESE INTERNATIONAL SCHOOL

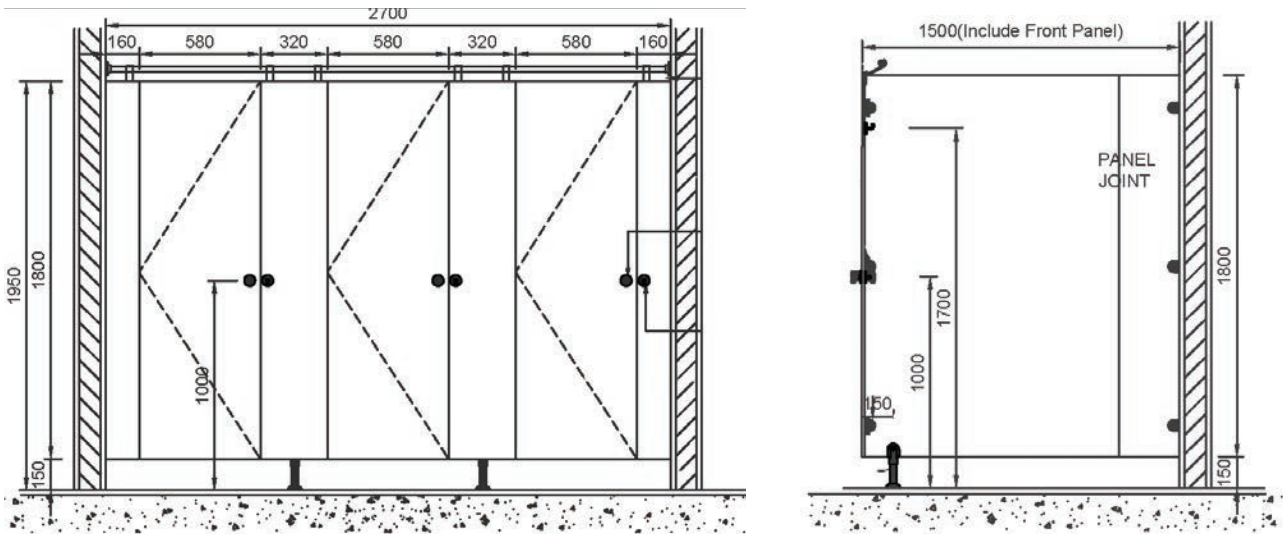
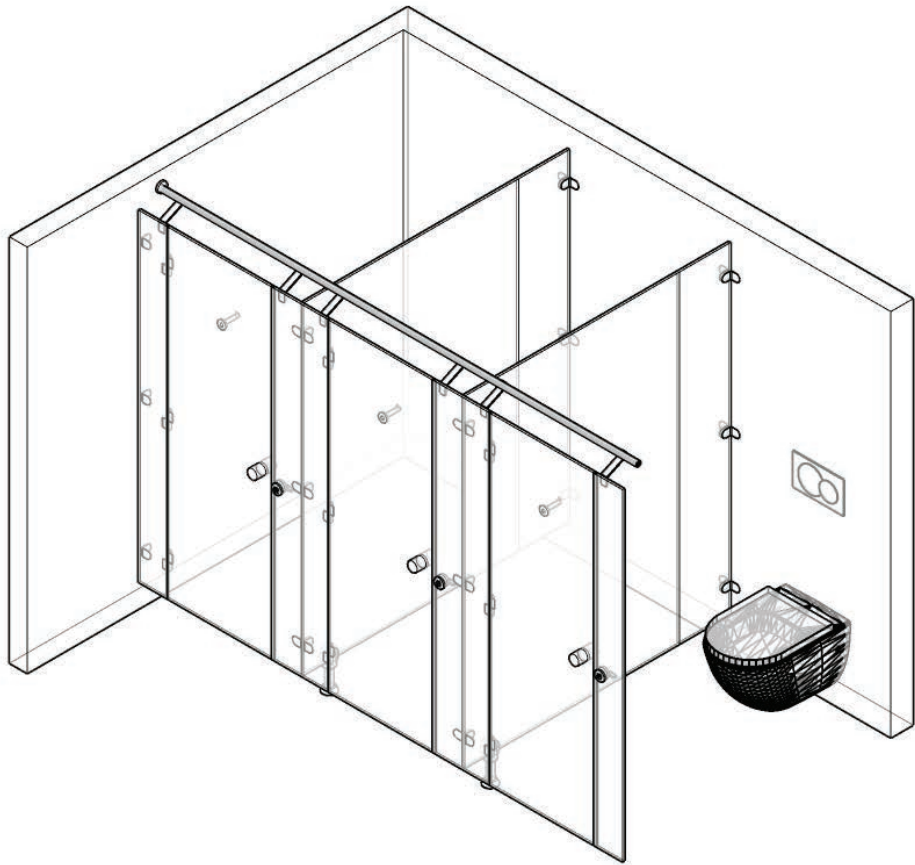

Hardware & Accessories



NIL-H01
Nylon Indicator Lock



NH-H01
Nylon Handle



NH-001
Nylon Hinge



NCH-002
Nylon Coathook



NAF-003
Nylon Anchor Foot

Carroza M2

Dimension Specification

Door
1800-2100 mm

Width
800-900 mm

Partitions
1500-1800 mm (FFL)

Floor Clearance
50 - 150 mm

Depths
1500 - 2400 mm

Material
12/13mm TUF water resistance compact panels with even black core according to EN 438 (BS EN 438-2 : 2005). CNC fabrication processing to ensure all sharp edges are rounded for enhanced safety.

Model
Carroza is the modern toilet cubicle system which delighted all specifiers with it's perfect outlook of 'Floating' design. The cubicle system type Carroza has feet that are recessed in the dividing walls, creating a floating impression.

Pilasters, Doors and Partitions
Pilasters, doors and partitions in 12/13mm TUF water resistance compact panels. Doors feature a flush design. Doors manufactured with all edges bevelled and corners rounded with 2 mm radius.

The recessed fixing system makes it visually appealing in comparison to standard toilet cubicles, yet also ensuring durability and quality in selection of material.

Hardware & Ironmongery
HED engineering ironmongeries must applied, including action hinges with soft closing, angle brackets with security screws, indicator lock with emergency opening and coat hook with integrated rubber door stopper.

Construction
12 or 18mm thick Stratificato panel of impregnated homogenous core with both sides decorative paper against melamine resin subjected to the combined action of pressure (9m Pa) and heat (150°C) in hydraulic presses core according to EN-438 absolutely moisture resistant, rot-proof, scratch and impact resistant, sturdily fitted together. Fabricated by CNC machine to ensure quality edge finish and safety corner.

Floor Anchors
HED SS316 Stainless Steel Anchor F1 Mechanism applied for floor-anchored system.

Finish Options
TUF Wood
TUF Solid Color



CARROZA S1



Offers Architects a perfectly engineered toilet partition system. It's stylish, elegant outlook and sturdy structure establish the most contemporary cubicle system.

This system can be customised to fit into any site's dimensions as well as in color and finish, which adds a sharp edge to contemporary designed cubicles.



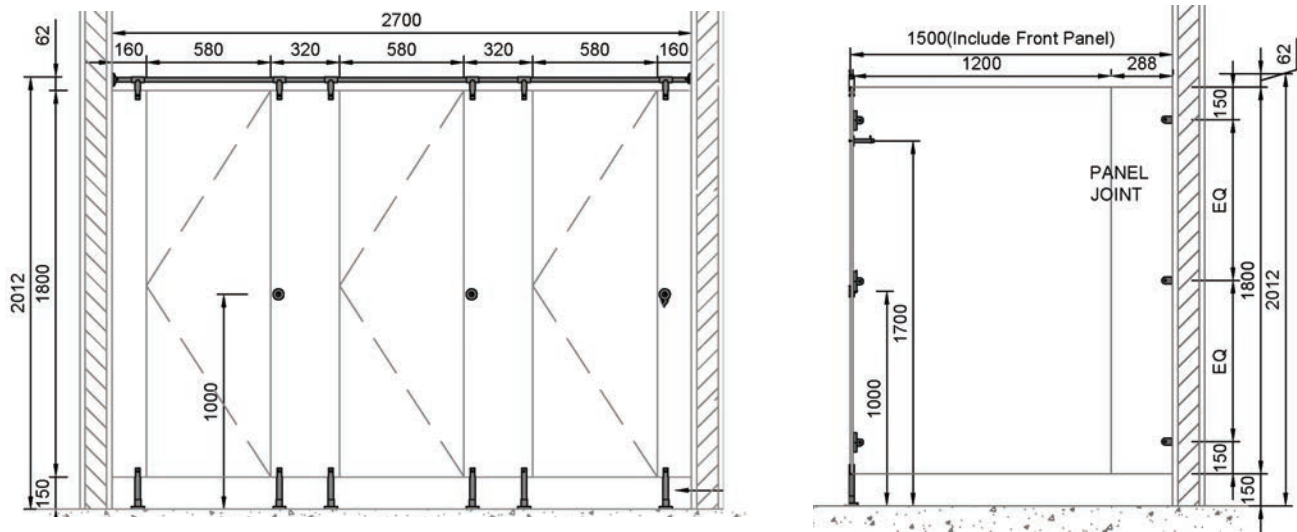
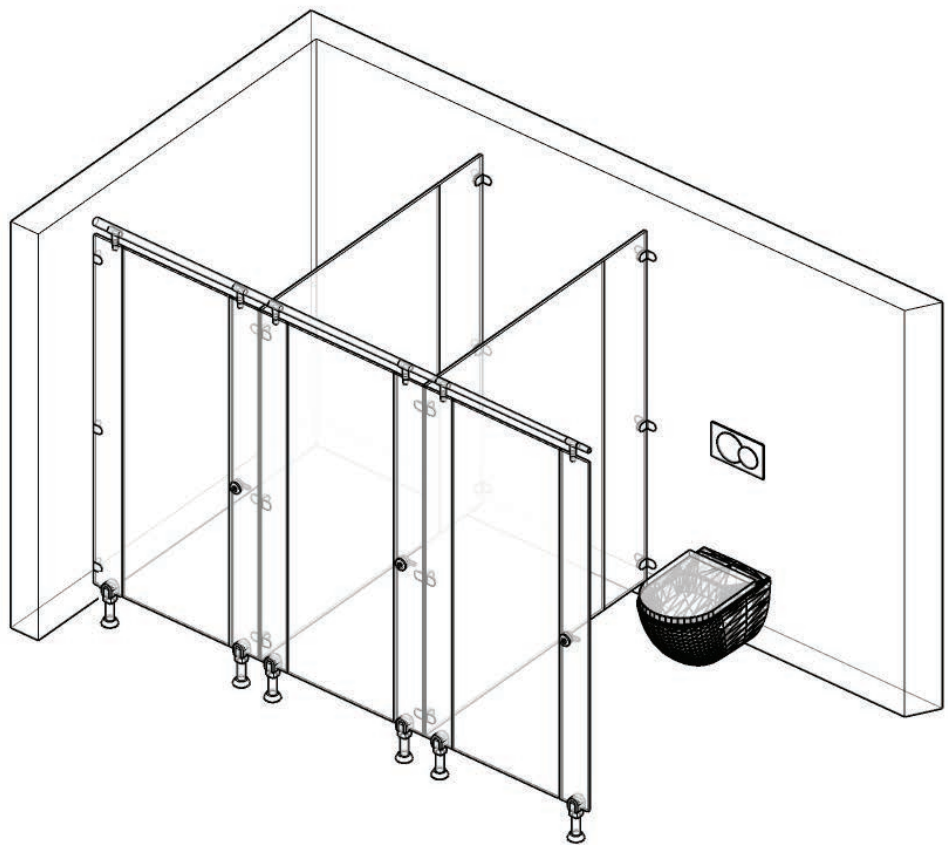

Hardware & Accessories



HED-SS1
304 / 316 Stainless Steel

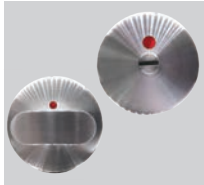

SS-IN1 Stainless Steel Door Lock



HED-DH01SS-1
304 / 316 Stainless Steel



SF-01SS
304 / 316 Stainless Steel Angle Brackett



HED-AL01SS
Stainless Steel Adjustable Leg



CH-01ASS
Stainless Steel Coat Hook

Carroza S1

Dimension

Door
800-900 mm
Doors 1800-2000 mm,

Division Panel:
1350-1500 mm

Pilaster:
1800-2100 mm (FFL)

Floor Clearance
50 - 150 mm

Standard Dimension

Width: 800-900 mm |
Depth: 1350-1500 mm | Heights:
Doors 1800-2100 mm, Partitions
1800-2200 mm (FFL)

Specification

Model

Genesis HED Carroza S1 Cubicle system made of HED TUF water resistance Stratificato panels with the finest stainless-steel ironmongery for stability, simplicity, durability and versatile product resistant to vandalism, impact and water.

Construction

Cubicle system made of 12/13mm TUF water resistance compact panels with the finest stainless steel ironmongery for maximum stability. This elegant, simplicity and robust Cubicle system is durable, economic and versatile product resistant to vandalism, impact and water.

Material

12/13mm TUF water resistance compact panels with even black core according to EN 438 (BS EN 438-2 : 2005). CNC fabrication processing to ensure all sharp edges are rounded for enhanced safety.

Pilasters, Doors and Partitions

Pilasters, doors and partitions in 12/13mm TUF water resistance compact panels. Stabilizing headrail with HED 2.0 panel holders for enhanced safety. Doors feature a flush design and all manufactured with all edges bevelled and corners rounded with 2 mm radius.

Hardware & Ironmongery

HED engineering ironmongeries must be applied, including gravity door hinges, angle brackets, indicator lock with emergency opening and coat hook with integrated rubber door stopper function. HED S316 Stainless Steel Adjustable 2.0 foot system

Floor Anchors

SS316 Stainless Steel Adjustable HED 2.0 foot system, corrosion and rust resistant.

Option:

Anti-bacterial panel is optional according to [JIS Z 2801:2000] standard.

Finish Options

TUF Wood
TUF Solid Color

HEDTM

**CARROZA
S2**



Wai Yip St. 128 Kwun Tong

Offers Architects a perfectly engineered toilet partition system. It's stylish, elegant outlook and sturdy structure establish the most contemporary cubicle system.

This system can be customised to fit into any site's dimensions as well as in color and finish, which adds a sharp edge to contemporary designed cubicles.



King Lam Estate Shopping Centre

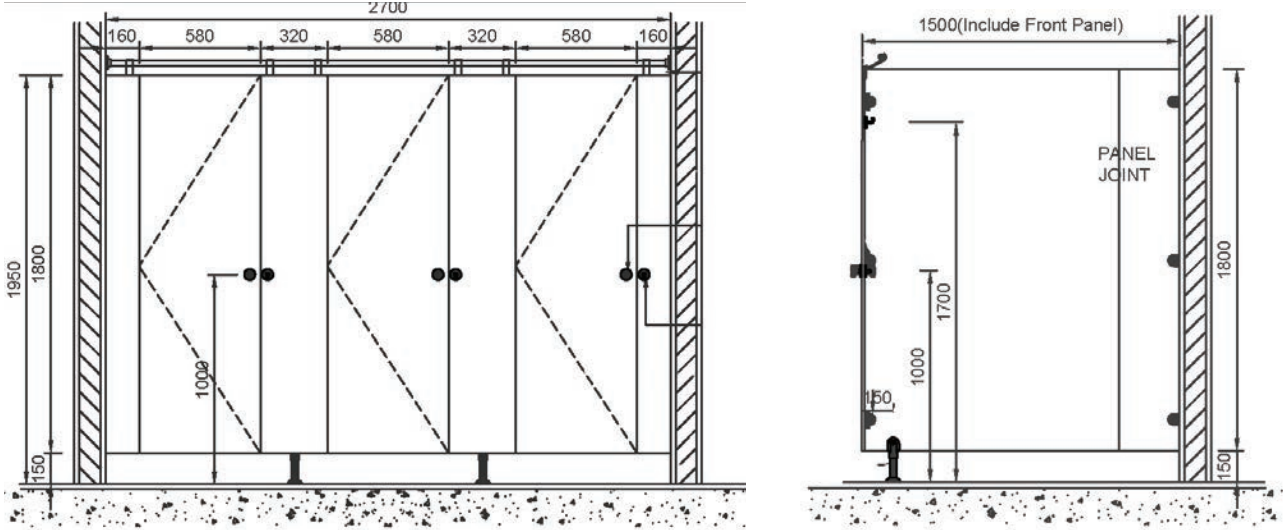
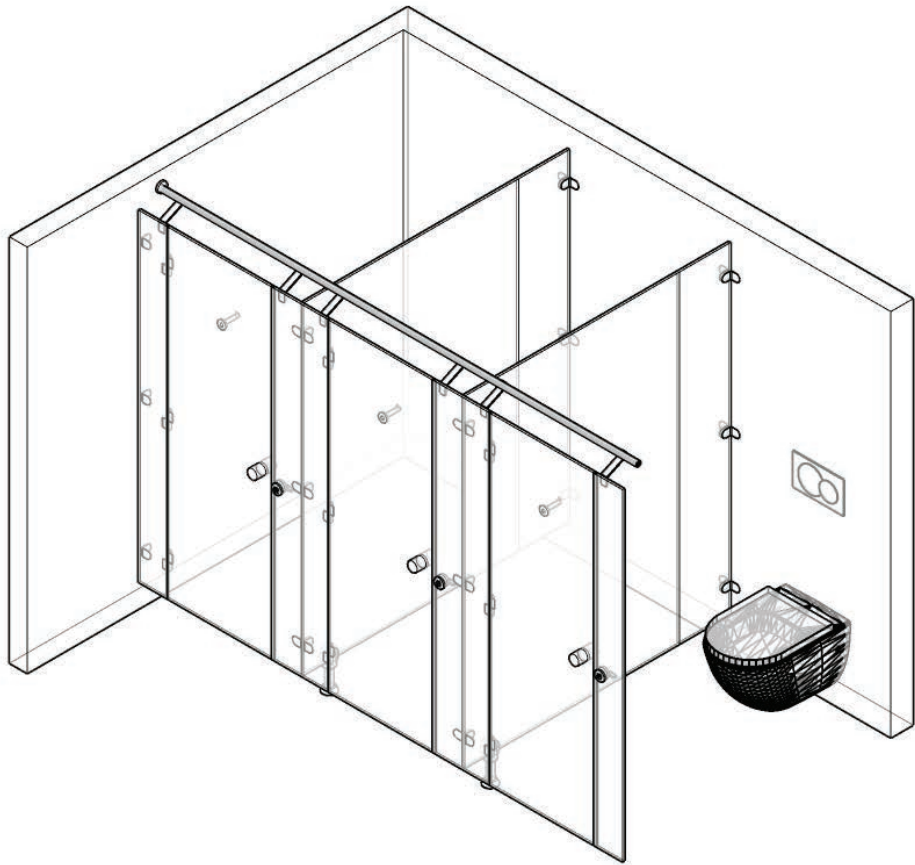

Hardware & Accessories



HED-SS1
304 / 316 Stainless Steel

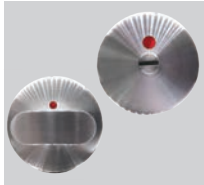

SS-IN1 Stainless Steel Door Lock



HED-DH01SS-1
304 / 316 Stainless Steel



SF-01SS
304 / 316 Stainless Steel Angle Bracket



HED-AL01SS
Stainless Steel Adjustable Leg



CH-01ASS
Stainless Steel Coat Hook

Carroza S2

Dimension

Specification

Door
800-900 mm
Doors 1800-2000 mm,

Division Panel:
1350-1500 mm

Pilaster:
1800-2100 mm (FFL)

Floor Clearance
50 - 150 mm

Standard Dimension

Width: 800-900 mm |
Depth: 1350-1500 mm | Heights:
Doors 1800-2100 mm, Partitions
1800-2200 mm (FFL)

Model

Genesis HED Carroza S1 Cubicle system was made of HED TUF water resistance Stratificato panels with the finest stainless-steel hidden headrail and ironmongery for stability, simplicity, durability and versatile product resistant to vandalism, impact and water.

Construction

12 or 13mm thick Stratificato panel of impregnated homogenous core with both sides decorative paper against melamine resin subjected to the combined action of pressure (9m Pa) and heat (150°C) in hydraulic presses core according to EN-438 absolutely moisture resistant, rot-proof, scratch and impact resistant, sturdily fitted together. Fabricated by CNC machine to ensure quality edge finish and safety corner.

Pilasters, Doors and Partitions

Pilasters, doors and partitions in 12/13mm TUF water resistance compact panels. Stabilizing headrail with HED 2.0 panel holders for enhanced safety. Doors feature a flush design and all manufactured with all edges bevelled and corners rounded with 2 mm radius.

Hardware & Ironmongery

HED engineering ironmongeries must be applied, including gravity door hinges, angle brackets, indicator lock with emergency opening and coat hook with integrated rubber door stopper function. HED S316 Stainless Steel Adjustable 2.0 foot system

Material

12/13mm TUF water resistance compact panels with even black core according to EN 438 (BS EN 438-2 : 2005). CNC fabrication processing to ensure all sharp edges are rounded for enhanced safety.

Option:

Anti-bacterial panel is optional according to [JIS Z 2801:2000] standard.

Finish Options

TUF Wood
TUF Solid Color

Toilet Cubicle Partitioning **Finish concept**

The Genesis Toilet Cubicle Partitioning system color concept contains both classic and modern colours
For a successful comfortable ambience, you may compile an individual cubicle system,
according to your own requirements.

Solid Color **Options**

Warm Color:

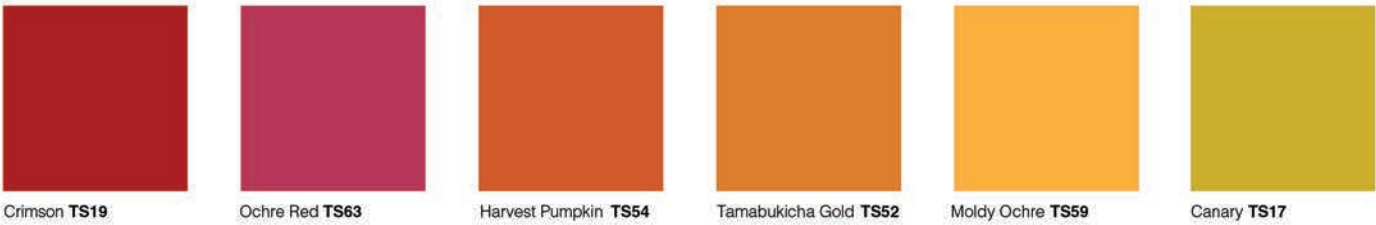

Cool Color:

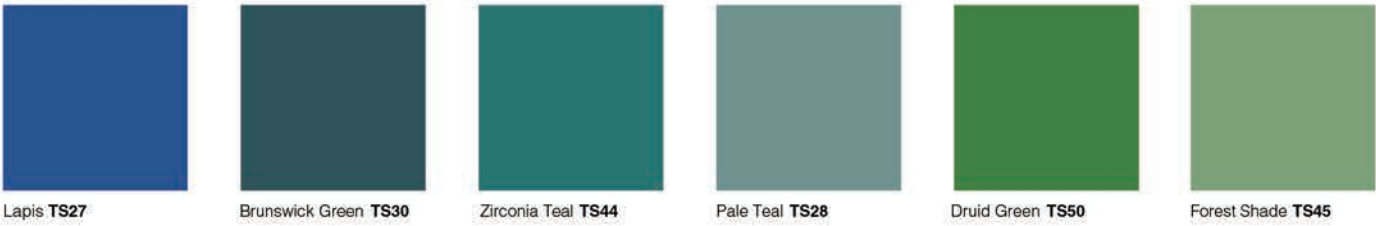

Light Color:

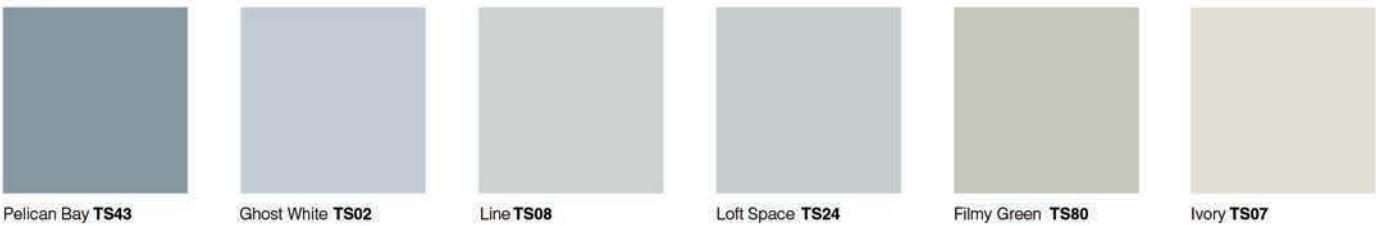

Dark Color:

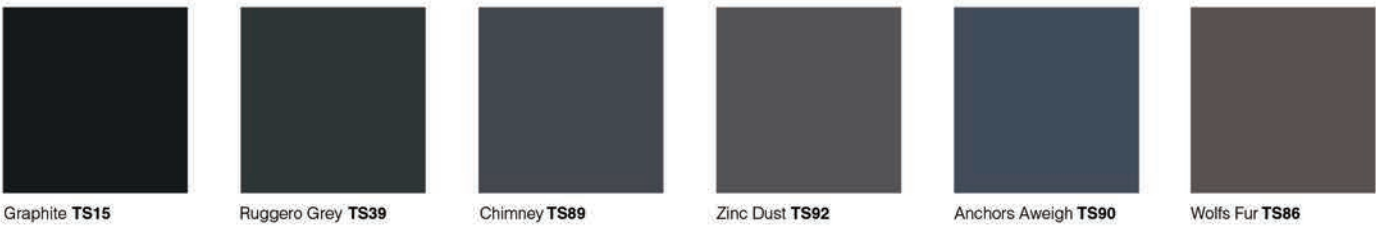

Standard Sheet Sizes

ST - 4' x 8' (1220 x 2440 mm) / MX - 4' x 10' (1220 x 3050 mm) / XL - 6' x 12' (1830 x 3660 mm)

Thickness

HPL Thickness: 0.6~1.2 mm / Compact Panel Thickness: 3~25 mm



Select from our impressive standard range of colours and finishes, or from our extended range for something more unique



Wood Finish **Options**



Metal Finish **Options**



MORE COLOR & FINISH AVAILABLE
Email: info@genesis361.com.hk



GENESIS



ANCHOR
COMPACT TOILET
CUBICLE SYSTEM

TEL: +852 2503 1868 | info@genesis361.com.hk | www.genesis361.com.hk

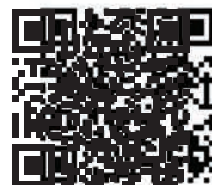

SCAN FOR INQUIRY